

DST-11-480/1S

DIGITAL CONTROLLED PHASE SHIFTER

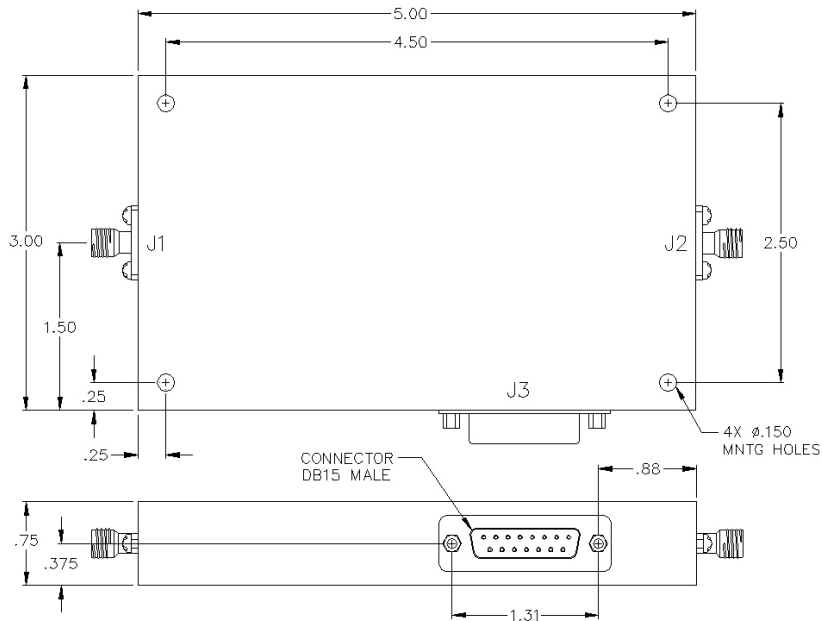

Logic Table

State	Pin 1	Pin 2	Pin 3	Pin 4	Pin 5	Pin 6	Pin 7	Pin 8	Phase (deg.)
-	1	1	1	1	1	1	1	1	0°
1	0	1	1	1	1	1	1	1	1.4°
2	1	0	1	1	1	1	1	1	2.8°
3	1	1	0	1	1	1	1	1	5.6°
4	1	1	1	0	1	1	1	1	11.2°
5	1	1	1	1	0	1	1	1	22.5°
6	1	1	1	1	1	0	1	1	45°
7	1	1	1	1	1	1	0	1	90°
8	1	1	1	1	1	1	1	0	180°

A combination of the above states will provide a phase shift equal to the sum of the selected states at center frequency.

Pin-Out

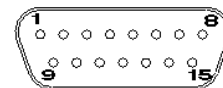

SPECIFICATIONS

Name: DST-11-480/1S
Frequency Range: 0.5-1 GHz
Insertion Loss: 4.5 dB max.
Number of Bits: 8
Least Significant Bit: 1.4° LSB
Phase Range: 360°
VSWR: 1.80:1 dB max.
Connector Type: SMA

Phase is $\pm 3.0\%$ at center frequency.
Other frequency bands and resolution ranges available.

Pin 01 = Phase: 1.4 (LSB) Pin 09 = N/C
Pin 02 = Phase: 2.8 Pin 10 = N/C
Pin 03 = Phase: 5.6 Pin 11 = N/C
Pin 04 = Phase: 11.25 Pin 12 = N/C
Pin 05 = Phase: 22.5 Pin 13 = +5 Vdc
Pin 06 = Phase: 45 Pin 14 = -5 Vdc
Pin 07 = Phase: 90 Pin 15 = Ground
Pin 08 = Phase: 180

This is a commercial off the shelf (COTS) product.
For an equivalent product that meets DFARS materials compliance, contact sales.
All specifications are subject to change without notice at any time. Rev: 180403

www.pulsarmicrowave.com · 48 Industrial St West, Clifton NJ 07012 · Tel: 973-779-6262 · Fax: 973-779-2727 · sales@pulsarmicrowave.com

PULSAR
MICROWAVE CORPORATION