

C50-100-481/1N

HIGH POWER 50 DB TYPE N DUAL DIRECTIONAL COUPLER

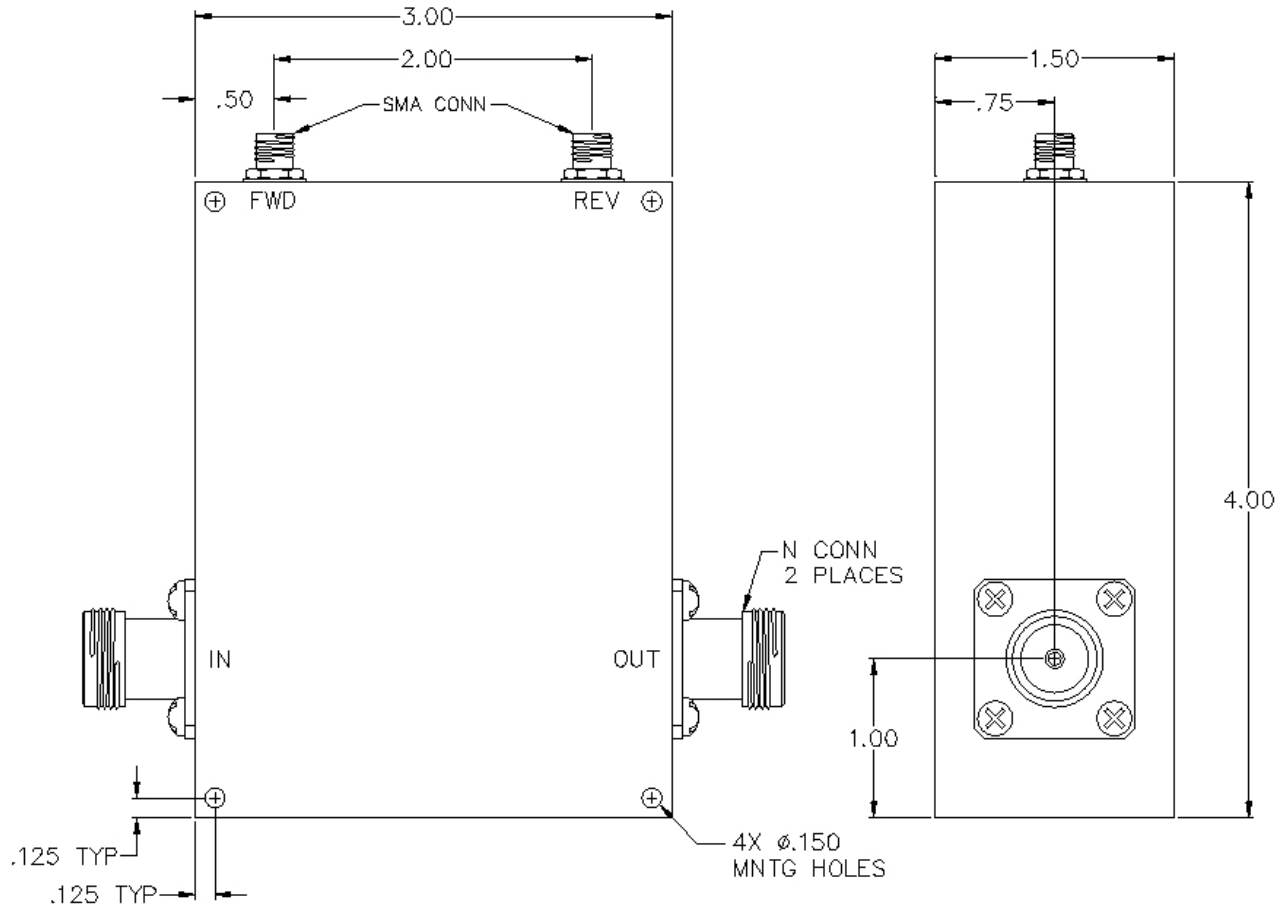
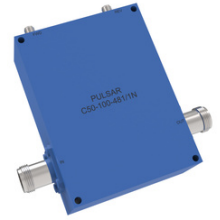

SPECIFICATIONS

Name:	C50-100-481/1N
Frequency Range:	0.5-50 MHz
Coupling:	50.0 \pm 1.00 dB
Coupling Flatness:	\pm 0.50 dB max.
Insertion Loss:	0.10 dB max.
Directivity:	20 dB min.
VSWR In/Out:	1.10:1 max.
Input Power:	2000 watts max.
Connector Type:	N

Insertion loss does not include coupling loss.
Input power is specified for load VSWR better than 1.20:1.

This is a commercial off the shelf (COTS) product.
For an equivalent product that meets DFARS materials compliance, contact sales.
All specifications are subject to change without notice at any time. Rev: 220628

