

# BT-09-411

## SMA BIAS TEE

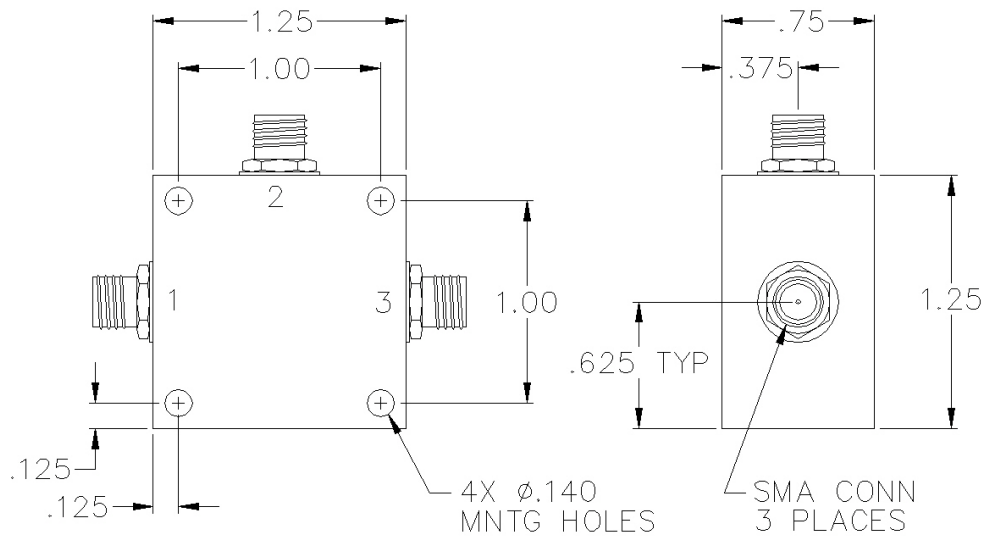

## SPECIFICATIONS

|                  |               |
|------------------|---------------|
| Name:            | BT-09-411     |
| Frequency Range: | 1700-2000 MHz |
| Insertion Loss:  | 0.7 dB max.   |
| Current:         | 1000 mA max.  |
| Power:           | 5 watts max.  |
| Voltage:         | 50 Vdc max.   |
| Isolation:       | 25 dB min.    |
| VSWR:            | 1.20:1 max.   |
| Package Type:    | SMA           |

## PORT CONFIGURATION

|                     |         |
|---------------------|---------|
| RF In (DC Blocked): | 1       |
| RF/DC Output:       | 3       |
| DC In (Bias):       | 2       |
| Ground:             | Housing |

This is a commercial off the shelf (COTS) product.  
For an equivalent product that meets DFARS materials compliance, contact sales.  
All specifications are subject to change without notice at any time. Rev: 190404

