

BT-04-411

SMA BIAS TEE

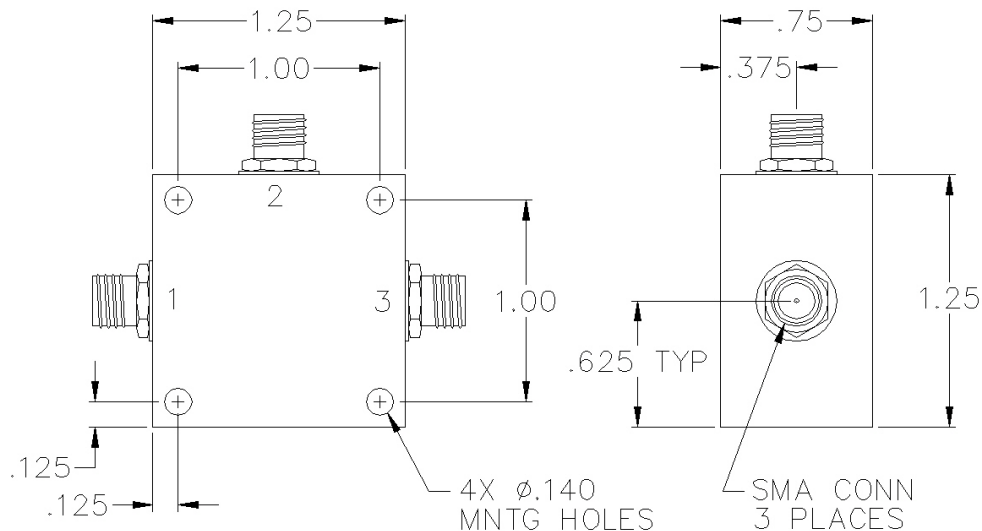

SPECIFICATIONS

Name:	BT-04-411
Frequency Range:	1000-5000 MHz
Insertion Loss:	1.0 dB max.
Current:	1000 mA max.
Power:	5 watts max.
Voltage:	50 Vdc max.
Isolation:	35 dB min.
VSWR:	1.50:1 max.
Package Type:	SMA

PORT CONFIGURATION

RF In (DC Blocked):	1
RF/DC Output:	3
DC In (Bias):	2
Ground:	Housing

This is a commercial off the shelf (COTS) product.

For an equivalent product that meets DFARS materials compliance, contact sales.

All specifications are subject to change without notice at any time. Rev: 220628