

BT-09-411

SMA BIAS TEE

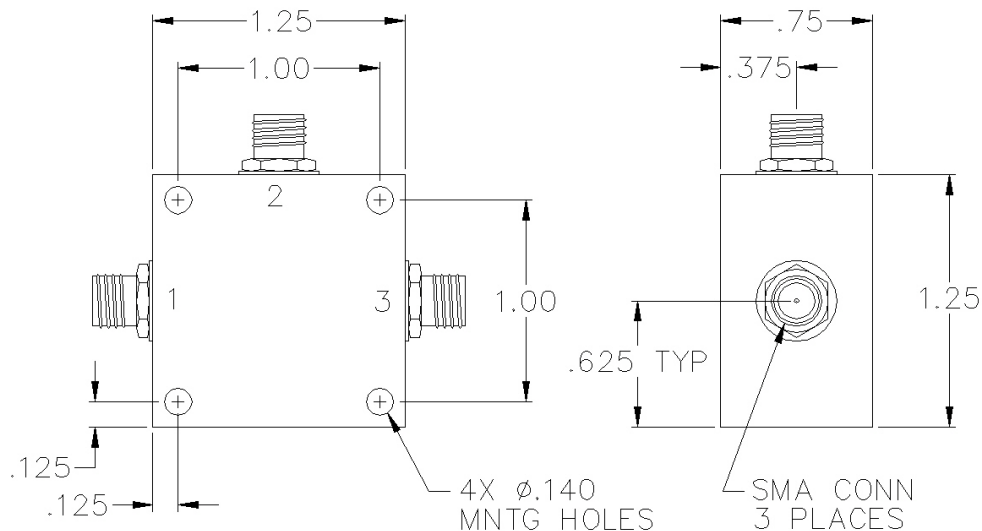

SPECIFICATIONS

| | |
|------------------|---------------|
| Name: | BT-09-411 |
| Frequency Range: | 1700-2000 MHz |
| Insertion Loss: | 0.7 dB max. |
| Current: | 1000 mA max. |
| Power: | 5 watts max. |
| Voltage: | 50 Vdc max. |
| Isolation: | 25 dB min. |
| VSWR: | 1.20:1 max. |
| Package Type: | SMA |

PORT CONFIGURATION

| | |
|---------------------|---------|
| RF In (DC Blocked): | 1 |
| RF/DC Output: | 3 |
| DC In (Bias): | 2 |
| Ground: | Housing |

This is a commercial off the shelf (COTS) product.

For an equivalent product that meets DFARS materials compliance, contact sales.

All specifications are subject to change without notice at any time. Rev: 220628